

ORION
 REF: FOUNDATION PLAN 1 OF 6
 BY: ELDAN HOMES, INC.
 DATED: OCTOBER 12, 2022

Min.:
 Front Setback: 35'
 Side Setback: 10' (ONE SIDE)
 25' (TOTAL)
 Rear Setback: 25'.

Subject to any statement of facts an accurate and up to date abstract of title will show.
 Unauthorized alteration or addition to a survey map bearing a licensed land surveyor's seal is a violation of section 7209, sub-division 2, of the New York State Education Law.

\\RSERVER\Land Projects\WILDFLOWER\DWG\HOUSES\LOT 5.dwg

TRACT MAP	
BY:	IANUZI & ROMANS LAND SURVEYING, P.C.
DATE FILED:	JUNE 3, 2020
MAP NO.	12934
PROPERTY CORNERS NOT SET THIS SURVEY, UNLESS SHOWN. OFFSETS FROM PROPERTY LINES MEASURED TO FOUNDATION WALLS, UNLESS OTHERWISE INDICATED.	
TO:	
THE UNDERSIGNED HEREBY CERTIFIES THAT THIS MAP IS MADE FROM AN ACTUAL SURVEY.	
N.Y.S. LICENSED LAND SURVEYOR	

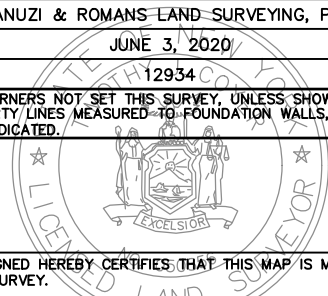

HOLLYSHIRE WAY

LOT No. 5
**THE ESTATES
 AT WILDFLOWER**
 SECTION No. 3
 PART OF MILITARY LOT No. 17
 TOWN OF CLAY
 ONONDAGA COUNTY, NEW YORK



**IANUZI & ROMANS
 LAND SURVEYING, P.C.**
 5251 WITZ DRIVE, NORTH SYRACUSE, NY. 13212
 PHONE: (315) 457-7200; FAX: (315) 457-9251
 EMAIL: mail@romanspc.com

DATE: OCTOBER 24, 2022
 SCALE: 1" = 60'
 FILE: 847.100 FB: